

Comfort-Cire® **Century**®
SE Series

Electric Gas Packaged Unit

RGP3060S1A
Parts List

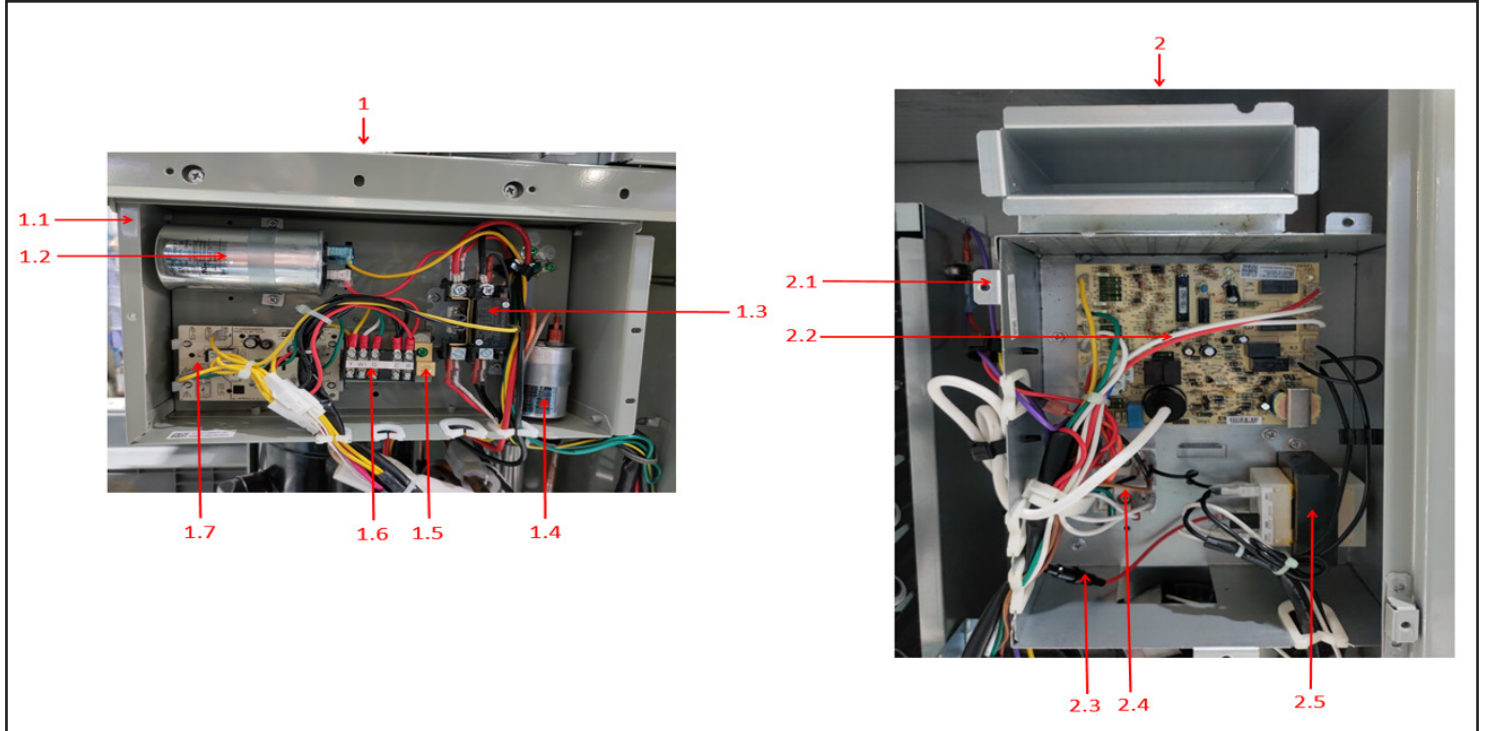
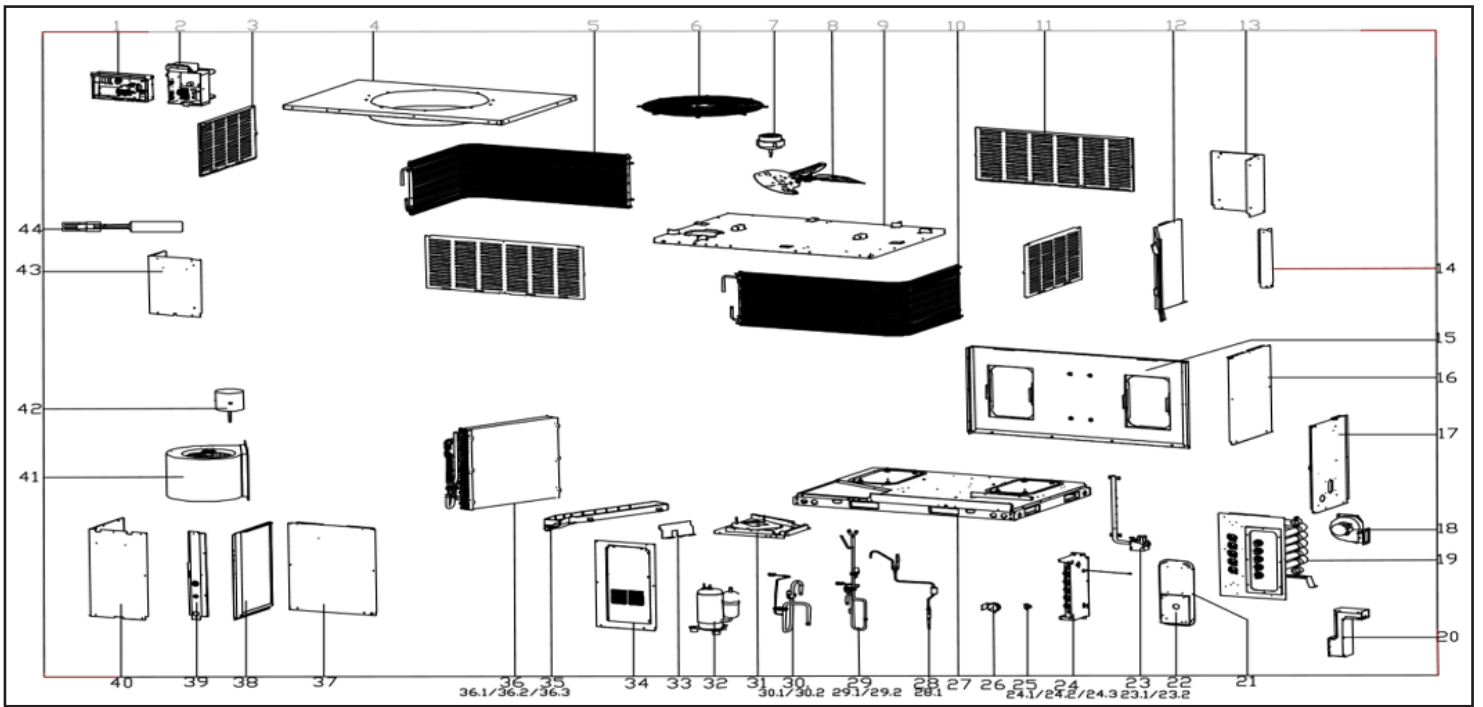

MARS®



Electric Gas Packaged Unit

RGP3060S1A Parts List

| EX ID | Spare Parts Code | Part Name(EN) | Qty. | Recommend store spare parts |
|-------|------------------|--|------|-----------------------------|
| 1 | 17227700A02474 | E-part box assembly | 1 | |
| 1.1 | 12227700A08021 | Electronic control box body assembly | 1 | |
| 1.2 | 17400103000147 | Capacitor | 1 | |
| 1.3 | 11203502000032 | AC contactor | 1 | YES |
| 1.4 | 17400103000152 | Capacitor | 1 | |
| 1.5 | 11201708000008 | Wiring Terminal | 1 | |
| 1.6 | 17400401001516 | Wire joint | 1 | YES |
| 1.7 | 17127700001166 | Main control board assembly | 1 | YES |
| 2 | 17227700001259 | E-part box assembly | 1 | |
| 2.1 | 12227700010298 | Electronic control box body assembly | 1 | |
| 2.2 | 17127600000648 | Gas furnace, Main control board assembly | 1 | YES |
| 2.3 | 17401203020513 | Strong electric cable group | 1 | |
| 2.4 | 17400401000208 | terminal block,2P | 1 | |
| 2.5 | 11203103000194 | Linear Transformer | 1 | YES |
| 3 | 12227700A07329 | Protective plate assembly | 2 | |
| 4 | 12227700A07342 | Top cover welding assembly | 1 | |
| 5 | 15827700001271 | Condenser part | 1 | YES |
| 6 | 12927700000341 | protection net | 1 | |
| 7 | 11002012000506 | Single Phase Asynchronous Motor | 1 | YES |
| 8 | 12200104000038 | Fan | 1 | YES |
| 9 | 12227700A08044 | Top cover assembly | 1 | |
| 10 | 15827700001273 | Condenser part | 1 | YES |
| 11 | 12227700A07323 | Protective plate assembly | 2 | |
| 12 | 12227700007504 | Partition board assembly | 1 | |
| 13 | 12227700A08040 | Outer panel | 1 | |
| 14 | 12227700008914 | Column | 2 | |
| 15 | 12227700A07338 | Internal panel assembly | 1 | |
| 16 | 12227700A07343 | Internal panel assembly | 1 | |
| 17 | 12227700A07374 | Pole 5 | 1 | |
| 18 | 17400801008424 | Exhaust fan ass'y | 1 | YES |
| 19 | 15727700000051 | Heat-exchanger ass'y | 1 | |

| EX ID | Spare Parts Code | Part Name(EN) | Qty. | Recommend store spare parts |
|-------|------------------|-------------------------------|------|-----------------------------|
| 20 | 12227700007444 | Flue pipe welding assembly | 1 | |
| 21 | 12227700007209 | Gas-collecting hood | 1 | |
| 22 | 12227700006981 | Exhaust baffle | 1 | |
| 23 | 15427700002352 | Gas Components | 1 | |
| 23.1 | 17427600001389 | Gas Valve | 1 | YES |
| 24 | 12227700010323 | Burner ass'y | 1 | |
| 24.1 | 17427600001429 | Firing pin | 1 | YES |
| 24.3 | 11201006000010 | Special sensor | 1 | YES |
| 25 | 17400513001095 | Thermostat | 1 | YES |
| 26 | 11201008000027 | Pressure sensor | 1 | YES |
| 27 | 12227700A08009 | Chassis part | 1 | |
| 28 | 15427700002359 | Throttle assembly | 1 | YES |
| 29 | 15427700002358 | Discharge pipe assembly B | 1 | |
| 29.1 | 17400516000628 | Pressure controller | 1 | YES |
| 29.2 | 15500301000035 | meter connector | 1 | YES |
| 30 | 15427700002362 | Suction pipe assembly | 1 | |
| 31 | 12227700008908 | Compressor base assembly | 1 | |
| 32 | 11103010014509 | Fixed Speed Rotary Compressor | 1 | YES |
| 33 | 12227700A08042 | Waterproof plate | 1 | |
| 34 | 12227700A08041 | Outer panel assembly | 1 | |
| 35 | 12127700000117 | Drainage pan assembly | 1 | YES |
| 36 | 15827700001229 | Evaporator assembly | 1 | YES |
| 37 | 12227700A07321 | Internal panel assembly | 1 | |
| 38 | 12227700A07340 | Internal panel assembly | 1 | |
| 39 | 12227700A08014 | Column assembly | 1 | |
| 40 | 12227700A07334 | Panel | 1 | |
| 41 | 12200102000175 | Centrifugal fan | 1 | YES |
| 42 | 11002015011928 | Brushless DC Motor | 1 | YES |
| 43 | 12227700A08016 | Column assembly | 1 | |
| 44 | 17400513000066 | Discharge temp sensor | 1 | YES |

Due to ongoing product improvements, specifications and dimensions are subject to change and correction without notice or incurring obligations. Determining the application and suitability for use of any product is the responsibility of the installer. Additionally, the installer is responsible for verifying dimensional data on the actual product prior to beginning any installation preparations.

Incentive and rebate programs have precise requirements as to product performance and certification. All products meet applicable regulations in effect on date of manufacture; however, certifications are not necessarily granted for the life of a product. Therefore, it is the responsibility of the applicant to determine whether a specific model qualifies for these incentive/rebate programs.



1900 Wellworth Ave., Jackson, MI 49203 • Ph. 517-787-2100 • www.marsdelivers.com

